



wePresent WiPG-1500

Wireless Interactive Presentation Gateway

WiPG -1500 is a powerful wireless presentation tool. New features on WiPG-1500 make it a "must have" gear for creating a much more interactive presentation.



New Features



Direct Draw

With new annotation function, users can annotate on projecting screen, or on a virtual white/black board without any input devices.



IWB/Touch Screen Support

User can do presentation via IWB/touch screen through driverless universal single-touch(UST) or install UoIP driver for multi-touch support.



Airpad

Write, draw and annotate on projecting screen via AirPad. Presenter can move freely by using AirPad to control the projecting PC/Mac.



Sender for Samsung Galaxy

Use MirrorOp sender to mirror the screen of your Galaxy devices. Bring your own Galaxy devices for presentation (BYOD).

Key Features



SidePad

Control the projection screen on PC or Mac via iOS or Android device



WiFi-Doc

High quality presentation via iOS or Android devices (Word, Excel, PPT, PDF, Photo, Screenshot)



DoWiFi

Wireless presentation for Windows and Mac (Win: XP/Vista/7/8, Mac: 10.6, 10.7, 10.8)



4-to-1 Projection

Project four PC/Mac screens or WiFi-Doc content to one projector/display at once



Conference Control/User-List

- Conference control function can be secured by password
- Moderator can control who is projecting.
- Moderator can compare 4 screens side by side.



WebSlides

- Broadcast slides to your devices with Wi-Fi and web browser
- Audience can save the projecting slides for taking notes
- WebSlides can be secured by password



SNMP v3

- Firmware upgrade via FTP
- Enhance the remote SNMP manageability to higher security level



Download with QR Code



Specification

Standards	IEEE 802.11b/g/n 2.4GHz IEEE 802.3 (10BASE-T) / IEEE 802.3u (100BASE-TX)
Management	Web-based configuration, SNMP V3
Security	IEEE Standard 64 / 128 bit WEP / WPA / WPA2-PSK / WPA-Enterprise / WPA2-Enterprise
Supported Output Resolution	VGA: SVGA (800x600) / XGA (1024x768) / WXGA (1280x768) / WXGA (1280x800) / WXGA (1360x768) / WXGA+ (1440x900) / UXGA (1600x1200) HDMI: HD720p (1280x720) / FHD1080i (1920x1080) / FHD1080p (1920x1080)
Supported Operation System	Windows XP/Vista/7/8, Mac OS X 10.5 and above WiFi-Doc and SidePad: Android 2.2 and above, iOS 3.2 and above
Power	External power adaptor DC 5V 2.6A
Interfaces	15Pin VGA, HDMI, RJ-45, USB 2.0 x 3, Power Button, Reset Button, Stereo Phone Jack
Certificate	FCC/CE/NCC





WiPG-1500

The WiPG or WePresent-1500 is a spectacular presentation tool. It allows a group of up to 64 users, connected by WiFi or through your own network, to wirelessly present from their Windows or Mac computer, smartphone or tablet.

New features on the WePresent-1500 make it the perfect tool for creating a much more interactive presentation environment.



Sender for Galaxy:
Use the new *Sender for Galaxy* app to mirror the screen of your Galaxy device to the WiPG-1500.



Special features:

- **VGA or HDMI output (up to 1080p)**
Connect WePresent to any VGA or HDMI monitor or projector, our resolution up to 1080p.
- **Conference Control (up to 64 users)**
Manage up to 64 concurrently connected users as moderator control which user is projecting.
- **4-Projection**
With the WePresent software (or through Conference Control) can easily compare 4 users side by side on 1 screen.
- **Wireless Access Point**
When connected to a (wireless) network, the WePresent can become wireless access point and give internet access.
- **SidePad (for Android/Apple)**
Use tablet or smartphone to remotely control any projecting Windows/Mac computer.
- **Wifi-Doc (for Android/Apple)**
Project any Powerpoint, Excel, Word, PDF files or photos from tablet or smartphone.
- **Plug-and-Show USB (now also for Mac) ^{NEW}**
Start WePresent software directly from a USB token. software installation, no Admin rights needed.
- **BrowserSlides (now also from Android/Apple) ^{NEW}**
Let audience receive slides from your presentation in browser on their own WiFi device and save them.
- **Wireless Touchscreen (Win/Mac driverless UST) ^{NEW}**
Connect touchscreen or interactive whiteboard and control projecting computer on the touchscreen. Wirelessly!
- **AirPad Controller ^{NEW}**
Write, and annotate, but also control any projecting computer using the special AirPad.
- **Annotate on the screen ^{NEW}**
Annotate the screen during your presentation, using your touchscreen AirPad or any other USB HID device.
- **Virtual whiteboard ^{NEW}**
Project actual white (or black) board on the screen. Then write, draw and annotate using your touchscreen, the AirPad, any other USB HID device. No connected computer needed!



The WePresent software interface:



NOW WITH HOTKEYS!

Use keyboard shortcuts for easy use of all the WePresent software functionality.

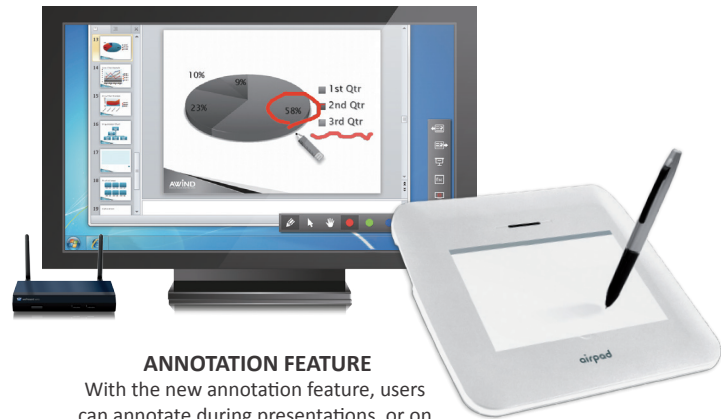

ANNOTATION FEATURE

With the new annotation feature, users can annotate during presentations, or on a virtual white (or black) board. Write and draw using the AirPad, your touchscreen or another USB device.

Standards	IEEE 802.11 b/g/n 2.5 GHz IEEE 802.3 (10BASE-T) / IEEE 8023u (100BASE-TX)
Security	IEEE Standard 64/128 bit WEP / WPA / WPA2-PSK / Enterprise
Management	Web-based configuration
Supported Output resolution	VGA: SVGA (800x600) / XGA (1024x768) / WXGA (1280x768) / WXGA (1280x800) / WXGA (1360x768) / WXGA+ (1440x900) / UXGA (1600x1200) HDMI: 720p (1280x720) / 1080p (1920x1080)
Supported Operating system	Windows XP / Vista / 7 / 8 , Mac OS X 10.5 and above, Android 2.2 and above, iOS 3.2 and above
Power	External power adaptor DC 5V 2.6A
Resources	15Pin VGA HDMI RJ-45 USB 2.0 x 3 Power button Reset Button Stereo Phone Jack
Certificate	FCC / CE